



TANK T2

User Manual

Content

1. Packing List	2
2. About the Smartwatch	3
3. About Watch Keys	4
4. Charging Tips	5
5. Pairing	6
6. Audio Settings	9
7. Settings on Watch Faces	15
8. Settings on Themes	16
9. Settings on “Sports Modes with Smart Recognition”	17
10. Quality Guarantee	19
11. FAQ	19
12. To Download User Manual in PDF	19
13. EIRP	19
14. Safety Tips	20
15. Disclaimer	20

1. Packing List

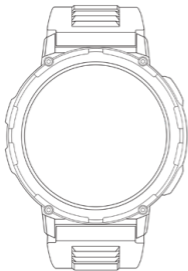

Smartwatch

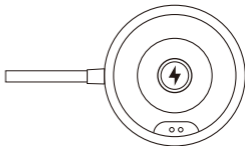

Magnetic Charging Base

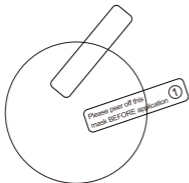

Tempered Glass



User Manual

2. About the Smartwatch



3. About Watch Keys

1) Power key:



a. Press and hold the power key for 2 seconds to turn on/off the watch.

b. Press the power key once:
Return to the previous menu /
Light up the display / Turn off
the display

2) Sports key:



a. Press the sports key once:
Turn on "Sports Mode".

b. Press the sports key twice:
Turn on "Voice Assistant".

c. Press and hold the sports
key for 2 seconds: Turn on
"SOS Emergency"

4. Charging Tips

- Please fully charge the watch before using it.



- When the magnetic charging base is working, please keep it away from any metal conductor to prevent a fire.



5. Pairing

1) Two Alternative Ways to Download the App (KOSPET FIT)

a. Scan the QR code below to download KOSPET FIT.



App QR code



KOSPET FIT

b. Enter "KOSPET FIT" in App Store or Google Play to download the App.



App Store



Health & Fitness
★★★★★ 58



Google Play



KOSPET FIT



KOSPET FIT
CRREPA

Install

2) Pair as Follows

a. When first using KOSPET FIT, please allow it to access Bluetooth on your compatible smartphone, location and grant other necessary permissions.

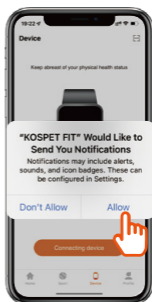
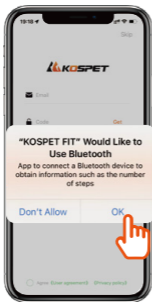

b. Enter "Device" in KOSPET FIT and tap "Connecting device" to find TANK T2 and tap "Pair".

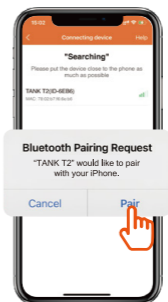

c. Allow KOSPET FIT to access notifications of your compatible smartphone on pairing the App with the smartwatch.

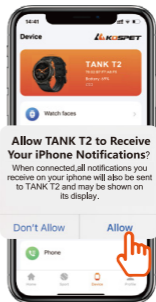

d. If necessary, you can set reminders for calls, SMS messages and applications in KOSPET FIT.

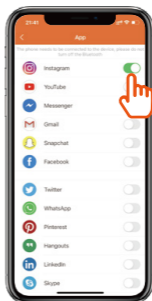
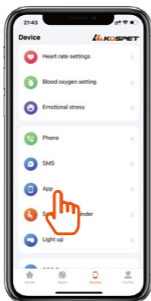

6. Audio Settings

1) Setting up Bluetooth Calling:

a. Up to 100 contacts on your compatible smartphone can be synced to the smartwatch via KOSPET FIT.



b. Set up emergency contacts in KOSPET FIT.

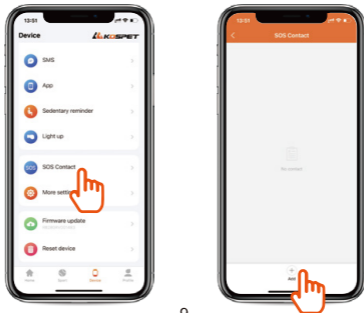

c. Tap  to enable or disable Bluetooth Calling.



d. Once Bluetooth Calling is enabled, you can receive incoming phone calls on the watch.



e. Once Bluetooth Calling is enabled, you can also make phone calls directly on the watch.



f. For users with smartphone systems of Android or below iOS 15.0, please connect Bluetooth audio on the smartwatch as follows to enable Bluetooth Calling.

Steps to Enable Bluetooth Calling on iOS Smartphones:

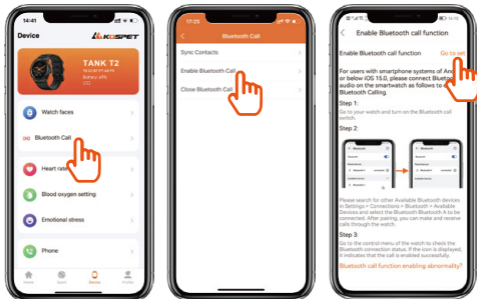

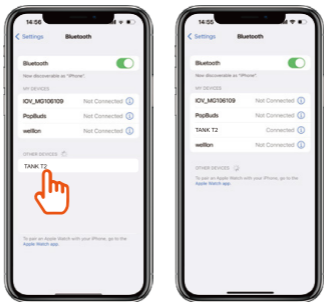

Steps to Enable Bluetooth Calling on Android Smartphones :

Step 1: Once you've connected your smartwatch with the App, please tap "PAIR" in Bluetooth pairing request to enable Bluetooth Calling.

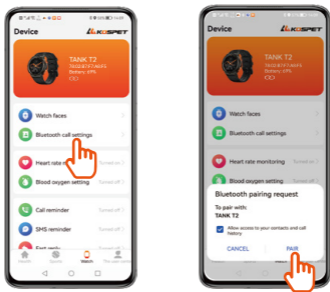

Step 2: Once you've connected your smartwatch with the App, please operate as follows to enable Bluetooth calling if you don't find the Bluetooth pairing request or you've tapped "CANCEL" by mistake.

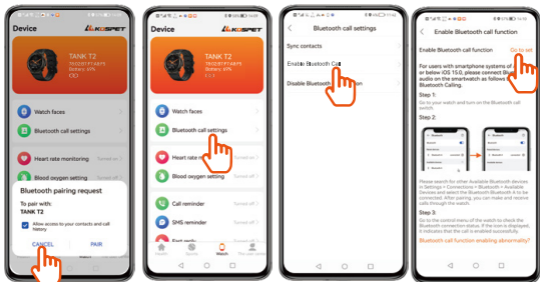

2) Setting up Multimedia Audio

a. Enter "Settings → Sound & Vibration" to turn on "Media audio", which allows the watch to sync and play audio from your compatible smartphone.





b. Once “Music” is enabled on the watch, it can play music from your compatible phone.



7. Settings on Watch Faces

1) Press and hold the watch face for 2 seconds, then swipe to quickly switch between watch faces.



2) Setting up Always-On Display

a. Enter "Settings → Watch face & theme" to enable "Always-On Display".



b. Setting up Watch Faces for "Always-On Display"

Enter "Settings → Watch face & theme → Always-On Display → theme" to switch watch faces for "Always-On Display"



8. Settings on Themes

a. Tap "  " to quickly switch between display styles of the menu.



9. Settings on “Sports Modes with Smart Recognition”

Enter “Settings → Sport recognition” to enable sports modes with smart recognition. The watch enables smart recognition of 6 sports -- stationary state, walking, running, cycling, elliptical and rower.



a. Walking can be activated by a continuous walk for 10 minutes.



b. Running can be activated by a continuous run for 3 minutes.



c. Elliptical and Rower can be activated by continuous exercises for 3 minutes on an elliptical trainer and a rowing machine respectively.



10. Quality Guarantee

Please learn more about KOSPET warranty policies via the link below:
<https://kospet.com/pages/returns-refund-policy>.

You can also contact our after-sales service via email:
after-sales@kospet.com

11. FAQ

Enter KOSPET FIT and select Help to view FAQ.

12. To Download User Manual in PDF

Scan the QR code below to enter KOSPET Official Community and download the user manual in PDF.



Official Community

13. Technical Specifications :

TX Frequency:	2402-2480 MHz
RX Frequency:	Bluetooth: 0.78 dBm Bluetooth LE: -6.45 dBm

14. Safety Tips :

- 1) Do not expose the watch to extremely high-temperature environments like scorching sun rays or around high-temperature devices like heaters, ovens, microwave ovens, or water heaters. High-temperature environments may cause battery explosions or other safety accidents.
- 2) The product includes an irremovable pure cobalt battery. Non-professionals are not allowed to disassemble it in case of a safety accident.
- 3) This product has passed multiple waterproof tests before launch. Considering different using habits, its internal parts may experience wear and tear, which affects its sealing performance. Therefore please wear and use the smartwatch carefully during swimming and diving, but avoid wearing it in a sauna room or for a hot shower.
- 4) Our products do not belong to medical apparatus. The heart rate, blood pressure and other health data collected by it are only for reference rather than clinical basis.

15. Disclaimer:

This user manual is published by KOSPET that owns the right of final interpretation. We may make adjustments to this manual anytime if necessary. All pictures for describing functions are for reference only.